

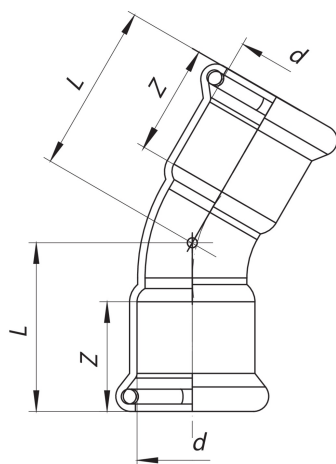

Curva 30° femmina.

Specifiche tecniche



| D | BAG | MASTER BOX | CODICE | L | Z |
|------|-----|------------|-----------|-------|------|
| 15 | 10 | 250 | 5N280015 | 27,8 | 19 |
| 18 | 10 | 250 | 5N280018 | 29,2 | 19,5 |
| 22 | 5 | 120 | 5N800022 | 31,7 | 21 |
| 28 | 5 | 60 | 5N280028 | 36 | 22 |
| 35 | 5 | 40 | 5N280035 | 61,3 | 27 |
| 42 | 2 | 30 | 5N280042 | 75,8 | 30 |
| 54 | 2 | 16 | 5N280054 | 90,5 | 35 |
| 76,1 | 1 | 6 | 5N280076 | 90,5 | 54 |
| 88,9 | 1 | 3 | 5N280088 | 101,5 | 61 |
| 108 | 1 | 2 | 5N2800108 | 131,4 | 76 |

Applicazioni



MARINE