

Manicotto F/filetto maschio.

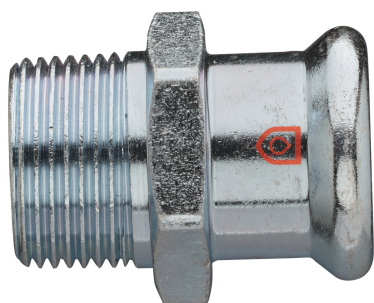

## Specifiche tecniche

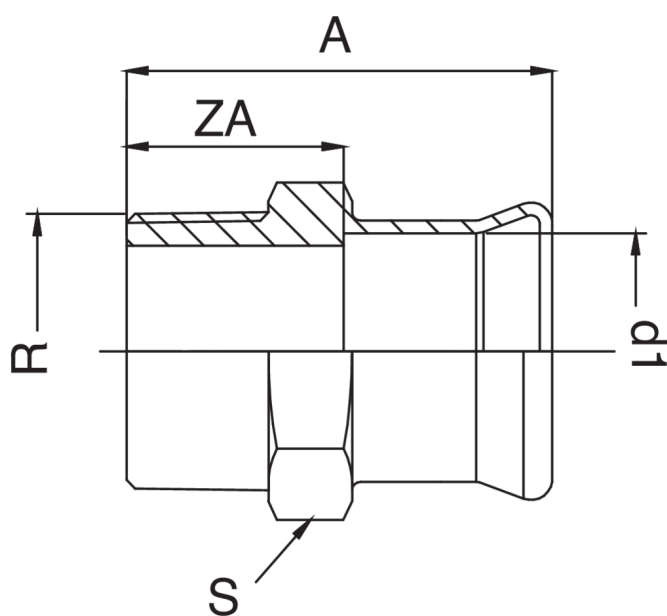

## Multiutility

| D1 X R     | BAG | MASTER BOX | CODICE          | A    | S  | ZA   |
|------------|-----|------------|-----------------|------|----|------|
| 35 x 1"1/4 | 5   | 40         | CMF243B14035000 | 55   | 46 | 29   |
| 42 x 1"1/2 | 5   | 20         | CMF243B12042000 | 55   | 55 | 25   |
| 54 x 2"    | 1   | 10         | CMF243C02054000 | 68,5 | 70 | 33,5 |

## Idrotermo sanitaria (ITS)

| D1 X R    | BAG | MASTER BOX | CODICE          | A    | S  | ZA   |
|-----------|-----|------------|-----------------|------|----|------|
| 15 x 3/8" | 10  | 100        | CMF243A38015000 | 34   | 24 | 14   |
| 15 x 1/2" | 10  | 150        | CMF243A12015000 | 37,5 | 24 | 17,5 |
| 15 x 3/4" | 10  | 200        | CMF243A34015000 | 46   | 19 | 16,3 |
| 18 x 1/2" | 10  | 150        | CMF243A12018000 | 37,5 | 27 | 17,5 |
| 18 x 3/4" | 10  | 100        | CMF243A34018000 | 41   | 27 | 21   |
| 22 x 1/2" | 10  | 100        | CMF243A12022000 | 40,5 | 32 | 17,5 |
| 22 x 3/4" | 10  | 100        | CMF243A34022000 | 44   | 32 | 21   |
| 22 x 1"   | 5   | 50         | CMF243B01022000 | 47   | 34 | 24   |
| 28 x 3/4" | 5   | 70         | CMF243A34028000 | 45   | 38 | 22   |
| 28 x 1"   | 5   | 50         | CMF243B01028000 | 48   | 38 | 25   |
| 35 x 1"   | 5   | 40         | CMF243B01035000 | 52   | 50 | 26   |

## Applicazioni



HEATING



HVAC



COMPRESSED  
AIR