

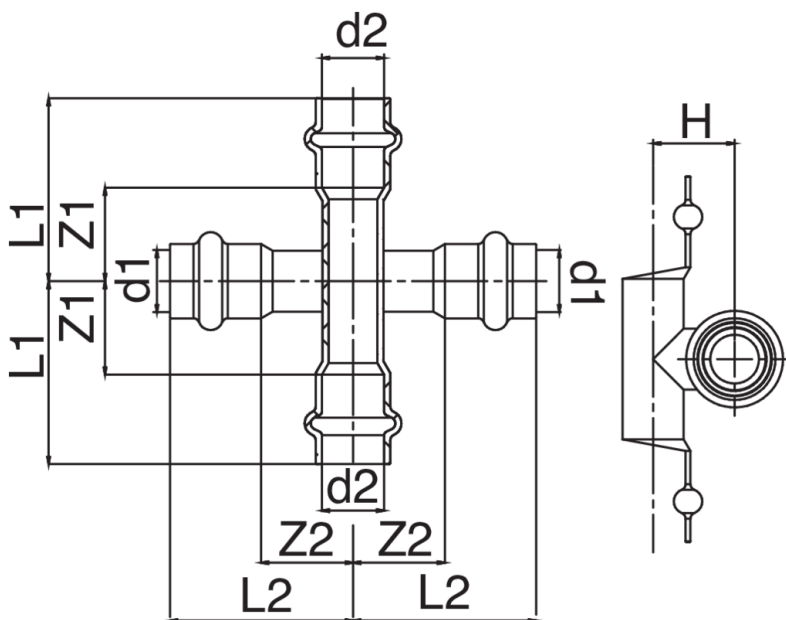

Raccordo a croce femmina disassata.



Specifiche tecniche



D1 X D2 X D1 X D2	BAG	MASTER BOX	CODICE	L1	L2	H	Z1	Z2
12 x 12 x 12 x 12	5	30	ZC0150012012000	40	40	28	22	22
15 x 12 x 15 x 12	5	50	ZC0150015012000	41	41	28	22	19
15 x 15 x 15 x 15	5	40	ZC0150015015000	41	41	28	19	19
18 x 15 x 18 x 15	5	40	ZC0150018015000	41	46	30	19	23
22 x 12 x 22 x 12	5	30	ZC0150022012000	40	49	32	22	25
22 x 15 x 22 x 15	5	30	ZC0150022015000	41	49	32	19	25
22 x 18 x 22 x 18	5	30	ZC0150022018000	46	49	33	23	25
28 x 15 x 28 x 15	5	20	ZC0150028015000	41	58	35	19	33
28 x 18 x 28 x 18	5	15	ZC0150028018000	46	58	36	23	33
28 x 22 x 28 x 22	5	30	ZC0150028022000	49	58	38	25	33
35 x 22 x 35 x 22	5	15	ZC0150035022000	49	58	41	25	32
42 x 22 x 42 x 22	1	10	ZC0150042022000	49	71	45	25	35
54 x 22 x 54 x 22	1	10	ZC0150054022000	49	82	51	25	42

Applicazioni



HEATING



HVAC



COMPRESSED
AIR