

Raccordo a T femmina ridotto.

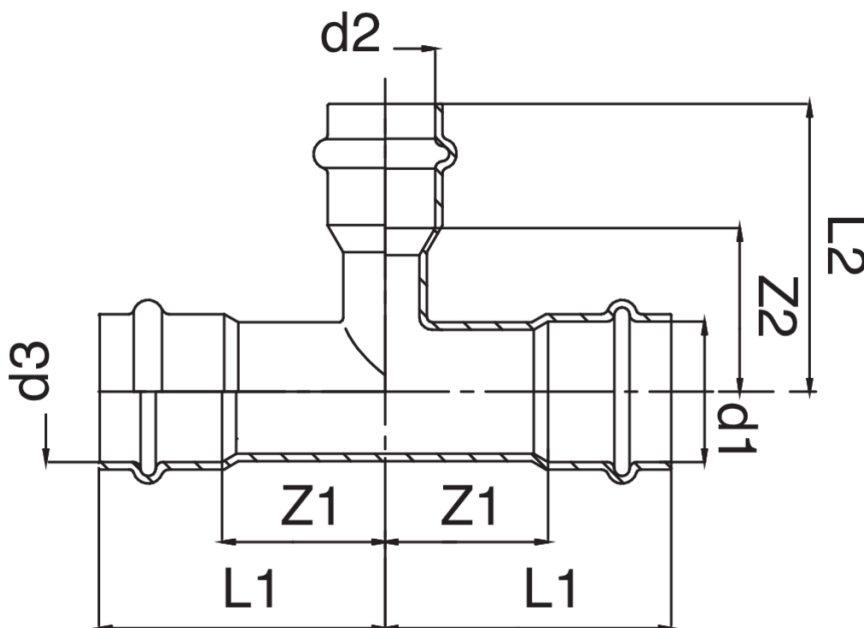

Specifiche tecniche



D1 X D2 X D3	BAG	MASTER BOX	CODICE	L1	L2	Z1	Z2
12 x 15 x 12	10	100	ZC0131012015012	29	39	11	21
15 x 12 x 12	10	50	ZC0131015012012	40	30	18	12
15 x 12 x 15	10	50	ZC0131015012015	41	42	19	24
15 x 22 x 15	10	70	ZC0131015022015	42	46	20	22
18 x 15 x 18	10	80	ZC0131018015018	45	42	22	20
18 x 22 x 18	5	50	ZC0131018022018	45	48	22	24
22 x 12 x 22	5	50	ZC0131022012022	49	39	25	21
22 x 15 x 22	5	50	ZC0131022015022	49	47	25	25
22 x 18 x 22	5	50	ZC0131022018022	49	45	25	22
22 x 28 x 22	5	40	ZC0131022028022	49	49	25	24
28 x 15 x 28	5	30	ZC0131028015028	54	56	29	34
28 x 18 x 28	5	30	ZC0131028018028	58	55	33	32
28 x 22 x 28	5	30	ZC0131028022028	58	54	33	30
35 x 15 x 35	5	25	ZC0131035015035	58	56	32	34
35 x 18 x 35	5	25	ZC0131035018035	58	58	32	35
35 x 22 x 35	5	20	ZC0131035022035	58	49	32	25
35 x 28 x 35	5	20	ZC0131035028035	58	61	32	36
42 x 22 x 42	3	15	ZC0131042022042	71	63	35	39
42 x 28 x 42	1	10	ZC0131042028042	71	64	35	39
42 x 35 x 42	1	10	ZC0131042035042	71	67	35	41
54 x 22 x 54	1	10	ZC0131054022054	82	72	42	48
54 x 28 x 54	1	10	ZC0131054028054	82	74	42	49
54 x 35 x 54	1	10	ZC0131054035054	82	76	42	50
54 x 42 x 54	1	10	ZC0131054042054	82	82	42	46

Disponibile versione big-size, art. AC0131 e art. ACM131.

Applicazioni



HEATING



HVAC



COMPRESSED
AIR