

**B4330G**

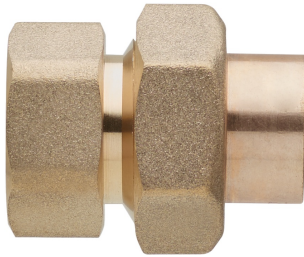

Union 3 pièces à joint plat + joint, F/filetage femelle.

Spécifications techniques

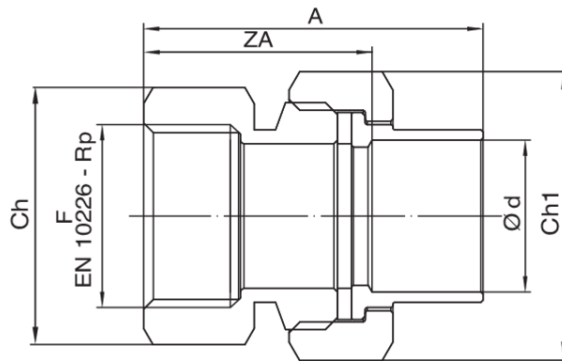

Ø D X F	BAG	MASTER BOX	CODE	A	ZA	CH	CH1
12 x 1/2"	10	100	B4330GA12012000	41	21,8	21	30
15 x 1/2"	10	100	B4330GA12015000	42	20,8	27	30
18 x 1/2"	10	100	B4330GA12018000	44	20,8	27	30
18 x 3/4"	10	100	B4330GA34018000	46,5	21,3	33	37
22 x 3/4"	10	60	B4330GA34022000	49	20,8	40	46
22 x 1"	5	50	B4330GB01022000	53	23,3	40	46
28 x 1"	10	40	B4330GB01028000	55,7	23,3	40	46
35 x 1"1/4	15	25	B4330GB14035000	60	24	40	46

# Applications



DRINKING WATER



HEATING



HVAC



GAS



COMPRESSED AIR



SOLAR



INDUSTRIAL