

Coude 90° F/filetage femelle en bronze.

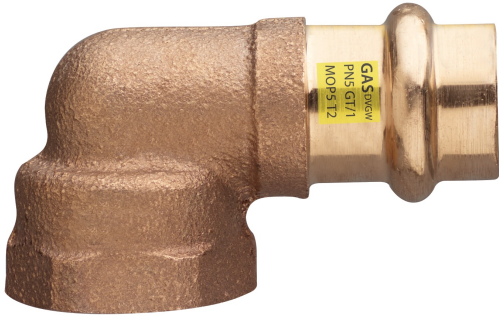

## Spécifications techniques

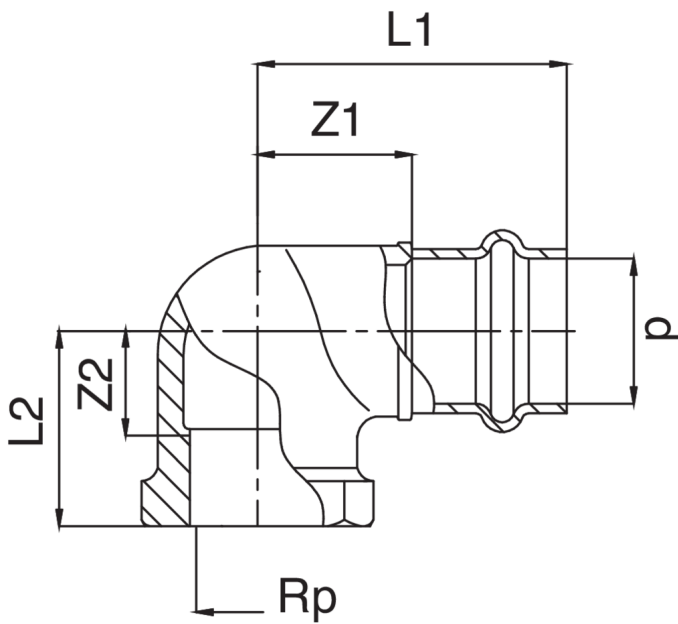

| D X RP     | BAG | MASTER BOX | CODE            | L1 | L2 | Z1 | Z2 |
|------------|-----|------------|-----------------|----|----|----|----|
| 12 x 3/8"  | 10  | 150        | PG8090A38012000 | 44 | 18 | 26 | 9  |
| 12 x 1/2"  | 10  | 150        | PG8090A12012000 | 44 | 22 | 26 | 11 |
| 15 x 3/8"  | 10  | 100        | PG8090A38015000 | 47 | 19 | 25 | 10 |
| 15 x 1/2"  | 10  | 100        | PG8090A12015000 | 45 | 24 | 23 | 13 |
| 15 x 3/4"  | 10  | 70         | PG8090A34015000 | 49 | 31 | 27 | 16 |
| 18 x 1/2"  | 10  | 100        | PG8090A12018000 | 47 | 24 | 24 | 13 |
| 18 x 3/4"  | 5   | 70         | PG8090A34018000 | 50 | 24 | 27 | 9  |
| 22 x 1/2"  | 10  | 60         | PG8090A12022000 | 49 | 24 | 25 | 13 |
| 22 x 3/4"  | 5   | 60         | PG8090A34022000 | 49 | 29 | 25 | 6  |
| 22 x 1"    | 5   | 40         | PG8090B01022000 | 60 | 33 | 36 | 10 |
| 28 x 1"    | 5   | 40         | PG8090B01028000 | 61 | 33 | 36 | 9  |
| 35 x 1"1/4 | 5   | 20         | PG8090B14035000 | 67 | 40 | 41 | 22 |
| 42 x 1"1/2 | 5   | 20         | PG8090B12042000 | 77 | 43 | 41 | 25 |
| 54 x 2"    | 1   | 8          | PG8090C02054000 | 97 | 57 | 57 | 39 |

## Applications



GAS



INDUSTRIAL



COMPRESSED  
AIR