

Manchon M/filetage mâle en bronze.

## Spécifications techniques

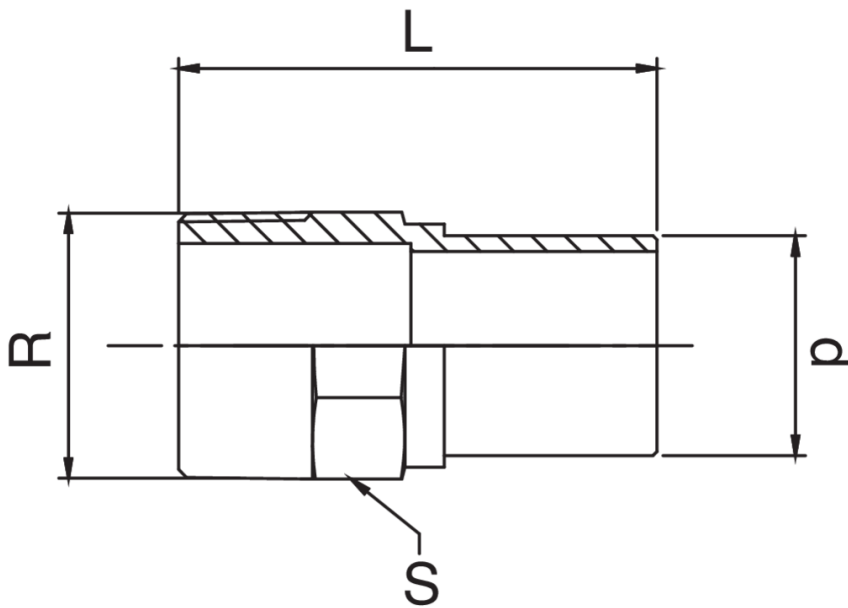

D X R	BAG	MASTER BOX	CODE	L	S
12 x 1/2"	10	200	RS8244A12012000	46	21
15 x 1/2"	10	200	RS8244A12015000	49	21
18 x 1/2"	10	150	RS8244A12018000	50	21
18 x 3/4"	10	100	RS8244A34018000	53	27
22 x 1/2"	10	100	RS8244A12022000	51	25
22 x 3/4"	10	100	RS8244A34022000	54	27
28 x 1"	5	50	RS8244B01028000	57	34
35 x 1"1/4	5	40	RS8244B14035000	64	42
42 x 1"1/2	5	25	RS8244B12042000	74	48
54 x 2"	1	10	RS8244C02054000	81	60

# Applications



GAS



INDUSTRIAL



COMPRESSED  
AIR