

Manchon M/filetage mâle en bronze.

## Spécifications techniques

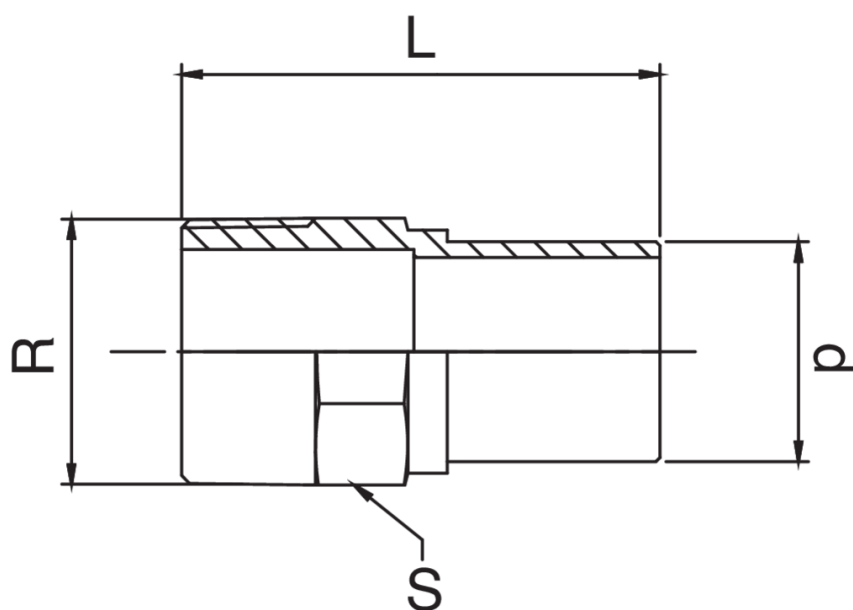

| D X R      | BAG | MASTER BOX | CODE            | L  | S  |
|------------|-----|------------|-----------------|----|----|
| 12 x 1/2"  | 10  | 200        | RS8244A12012000 | 46 | 21 |
| 15 x 1/2"  | 10  | 200        | RS8244A12015000 | 49 | 21 |
| 18 x 1/2"  | 10  | 150        | RS8244A12018000 | 50 | 21 |
| 18 x 3/4"  | 10  | 100        | RS8244A34018000 | 53 | 27 |
| 22 x 1/2"  | 10  | 100        | RS8244A12022000 | 51 | 25 |
| 22 x 3/4"  | 10  | 100        | RS8244A34022000 | 54 | 27 |
| 28 x 1"    | 5   | 50         | RS8244B01028000 | 57 | 34 |
| 35 x 1"1/4 | 5   | 40         | RS8244B14035000 | 64 | 42 |
| 42 x 1"1/2 | 5   | 25         | RS8244B12042000 | 74 | 48 |
| 54 x 2"    | 1   | 10         | RS8244C02054000 | 81 | 60 |

# Applications



DRINKING WATER



HEATING



HVAC



COMPRESSED AIR



FIREFIGHTING