

## RB3331

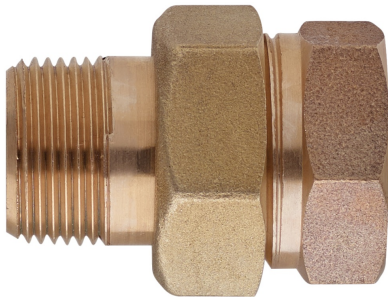

Unión recta 3 piezas sede plana rosca macho/hembra + junta.

### Especificaciones técnicas

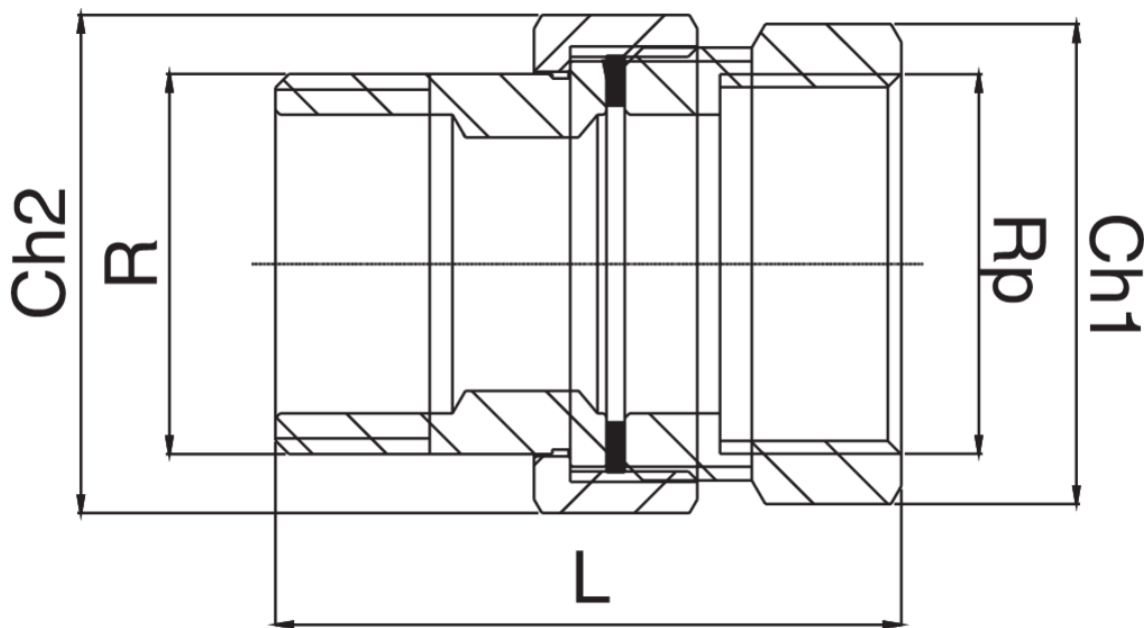

R/RP	BAG	MASTER BOX	CÓDIGO	CH1	CH2	L
3/8"	5	150	RB3331A38A38000	24	27	44
1/2"	5	100	RB3331A12A12000	27	30	47,5
3/4"	5	50	RB3331A34A34000	34	37	53,5
1"	5	40	RB3331B01B01000	42	46	61,5
1"1/4	1	20	RB3331B14B14000	50	52	69,5
1"1/2	1	15	RB3331B12B12000	56	64	88
2"	1	8	RB3331C02C02000	70	82	96

# Aplicaciones



DRINKING WATER



HEATING



HVAC



GAS



COMPRESSED AIR



SOLAR



FIREFIGHTING