

## RB3301

Tapón rosca hembra.

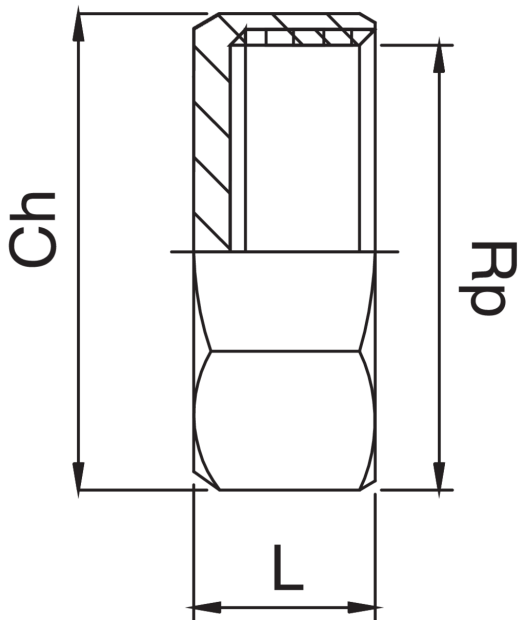

### Especificaciones técnicas



| RP    | BAG | MASTER BOX | CÓDIGO          | CH | L  |
|-------|-----|------------|-----------------|----|----|
| 3/8"  | 10  | 300        | RB3301A38000000 | 21 | 13 |
| 1/2"  | 10  | 80         | RB3301A12000000 | 25 | 16 |
| 3/4"  | 10  | 80         | RB3301A34000000 | 31 | 18 |
| 1"    | 10  | 150        | RB3301B01000000 | 38 | 21 |
| 1"1/4 | 5   | 80         | RB3301B14000000 | 48 | 23 |
| 1"1/2 | 5   | 80         | RB3301B12000000 | 55 | 23 |
| 2"    | 5   | 40         | RB3301C02000000 | 66 | 24 |

## Aplicaciones



DRINKING  
WATER



HEATING



HVAC



GAS



COMPRESSED  
AIR



SOLAR



FIREFIGHTING