

OT5537

Racór portagoma tipo Roma.

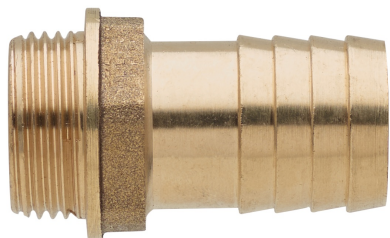

Especificaciones técnicas

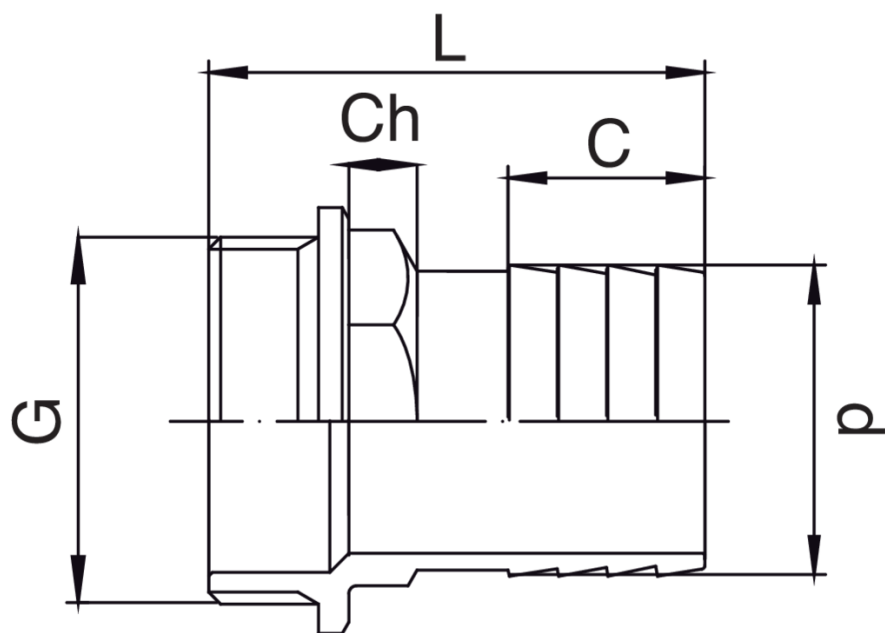

D X G	BAG	MASTER BOX	CÓDIGO	L	C	CH
12 x 1/2"	10	300	OT5537A12012000	41,5	25,7	16
14 x 1/2"	10	300	OT5537A12014000	41,5	27,5	21
16 x 1/2"	10	250	OT5537A12016000	41,5	27	21
18 x 1/2"	10	250	OT5537A12018000	41,5	27	21
20 x 1/2"	10	100	OT5537A12020000	41,5	27	21
20 x 3/4"	10	100	OT5537A34020000	49	39	22
25 x 3/4"	10	100	OT5537A34025000	50,5	32,5	28
25 x 1"	10	100	OT5537B01025000	51,5	32	30
30 x 1"	10	100	OT5537B01030000	52,5	32	32

Aplicaciones



DRINKING WATER



HEATING



HVAC



GAS



COMPRESSED AIR



SOLAR



FIREFIGHTING