

OT5517

Tuerca de unión rosca hembra ISO 228/1.

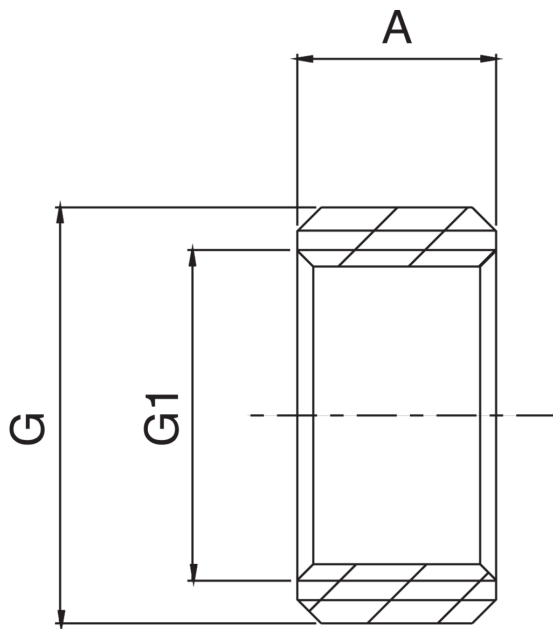

Especificaciones técnicas



| G X G1 | BAG | MASTER BOX | CÓDIGO | A |
|-------------|-----|------------|-----------------|----|
| 3/8" x 1/4" | 10 | 200 | OT5517A38A14000 | 10 |
| 1/2" x 3/8" | 10 | 500 | OT5517A12A38000 | 10 |
| 3/4" x 1/2" | 10 | 500 | OT5517A34A12000 | 10 |
| 1" x 3/4" | 10 | 150 | OT5517B01A34000 | 13 |

Aplicaciones



DRINKING WATER



HEATING



HVAC



GAS



COMPRESSED AIR



SOLAR



FIREFIGHTING