

## OT5520

Manguito rosca macho/macho.

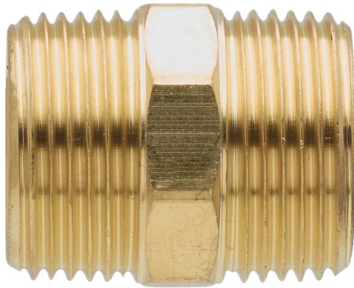

### Especificaciones técnicas

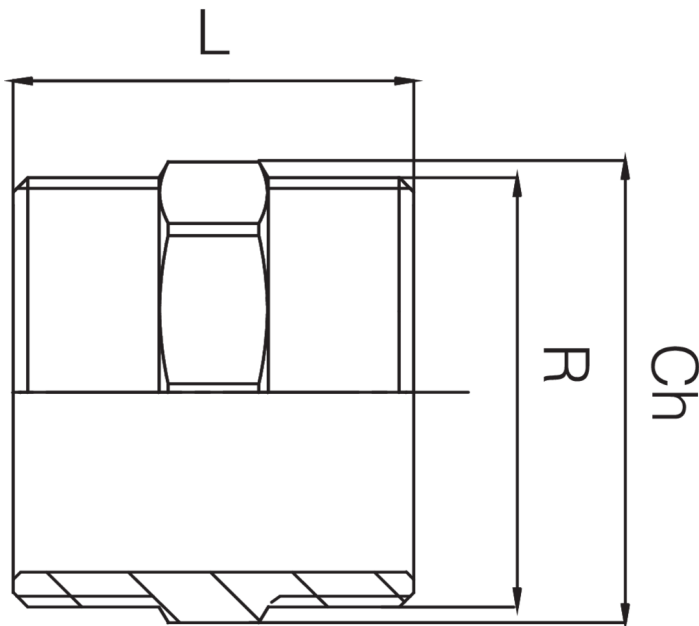

| R     | BAG | MASTER BOX | CÓDIGO          | L  | CH |
|-------|-----|------------|-----------------|----|----|
| 1/4"  | 10  | 100        | OT5520A14A14000 | 22 | 14 |
| 3/8"  | 10  | 300        | OT5520A38A38000 | 26 | 17 |
| 1/2"  | 10  | 250        | OT5520A12A12000 | 28 | 21 |
| 3/4"  | 10  | 150        | OT5520A34A34000 | 31 | 27 |
| 1"    | 10  | 100        | OT5520B01B01000 | 40 | 34 |
| 1"1/4 | 5   | 50         | OT5520B14B14000 | 45 | 42 |
| 1"1/2 | 5   | 40         | OT5520B12B12000 | 47 | 48 |
| 2"    | 5   | 25         | OT5520C02C02000 | 55 | 60 |
| 2"1/2 | 5   | 10         | OT5520C12C12000 | 65 | 90 |
| 3"    | 5   | 25         | OT5520D03D03000 | 75 | 95 |

# Aplicaciones



DRINKING WATER



HEATING



HVAC



GAS



COMPRESSED AIR



SOLAR



FIREFIGHTING