

RB4246

Manguito mixto M/rosca hembra.

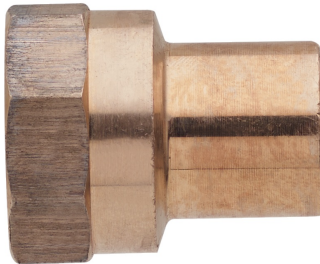

Especificaciones técnicas

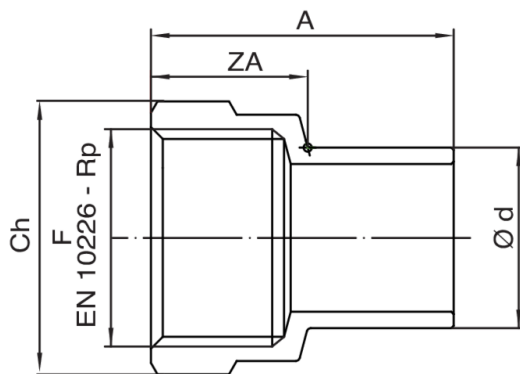

Ø D x F	BAG	MASTER BOX	CÓDIGO	A	ZA	CH
12 x 3/8"	10	300	RB4246A38012000	25,1	14	21
12 x 1/2"	10	200	RB4246A12012000	29,5	18,4	25
15 x 3/8"	10	300	RB4246A38015000	26,2	13,1	21
15 x 1/2"	10	100	RB4246A12015000	30,6	17,5	25
18 x 1/2"	10	100	RB4246A12018000	32,9	17,8	25
22 x 1/2"	10	150	RB4246A12022000	36	18,1	25
22 x 3/4"	10	100	RB4246A34022000	37,1	19,2	31
28 x 1"	5	100	RB4246B01028000	43,4	22,5	38
35 x 1"1/4	5	30	RB4246B14035000	50,7	25,2	48
42 x 1"1/2	5	30	RB4246B12042000	54,2	24,7	56

Aplicaciones



DRINKING WATER



HEATING



HVAC



GAS



COMPRESSED AIR



SOLAR



INDUSTRIAL