

Manguito mixto H/rosca macho.

Especificaciones técnicas

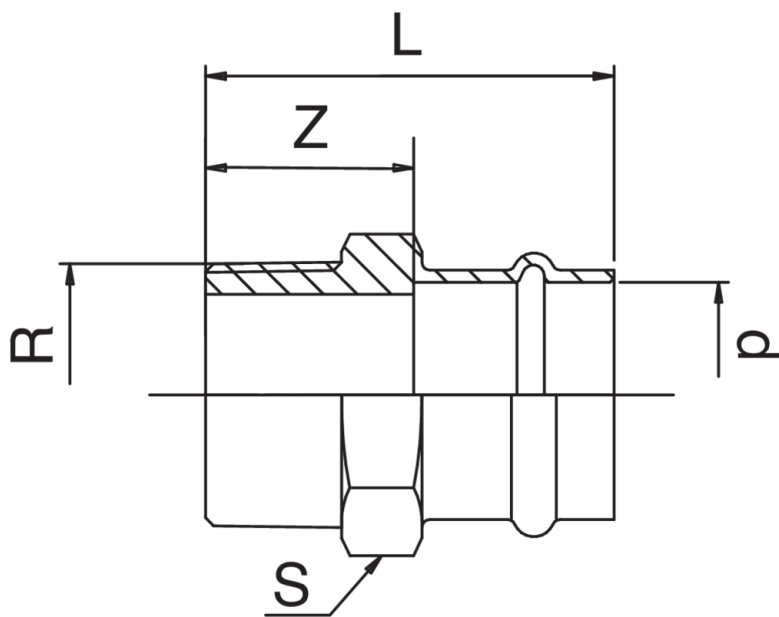

| D X R | BAG | MASTER BOX | CÓDIGO | L | S | Z |
|------------|-----|------------|-----------------|-----|----|----|
| 15 x 1/2" | 10 | 50 | GXF243A12015000 | 43 | 23 | 21 |
| 18 x 1/2" | 10 | 150 | GXF243A12018000 | 62 | 22 | 21 |
| 18 x 3/4" | 10 | 30 | GXF243A34018000 | 49 | 30 | 26 |
| 22 x 1/2" | 5 | 100 | GXF243A12022000 | 46 | 31 | 20 |
| 22 x 3/4" | 10 | 50 | GXF243A34022000 | 47 | 31 | 21 |
| 22 x 1" | 10 | 50 | GXF243B01022000 | 55 | 34 | 31 |
| 28 x 3/4" | 5 | 70 | GXF243A34028000 | 47 | 32 | 22 |
| 28 x 1" | 5 | 50 | GXF243B01028000 | 49 | 36 | 24 |
| 35 x 1" | 5 | 40 | GXF243B01035000 | 70 | 36 | 52 |
| 35 x 1"1/4 | 5 | 40 | GXF243B14035000 | 81 | 45 | 55 |
| 42 x 1"1/2 | 1 | 20 | GXF243B12042000 | 86 | 48 | 51 |
| 54 x 2" | 1 | 15 | GXF243C02054000 | 100 | 60 | 60 |

Aplicaciones



GAS



COMPRESSED
AIR



INDUSTRIAL