

T H/H/H de cobre.

## Especificaciones técnicas

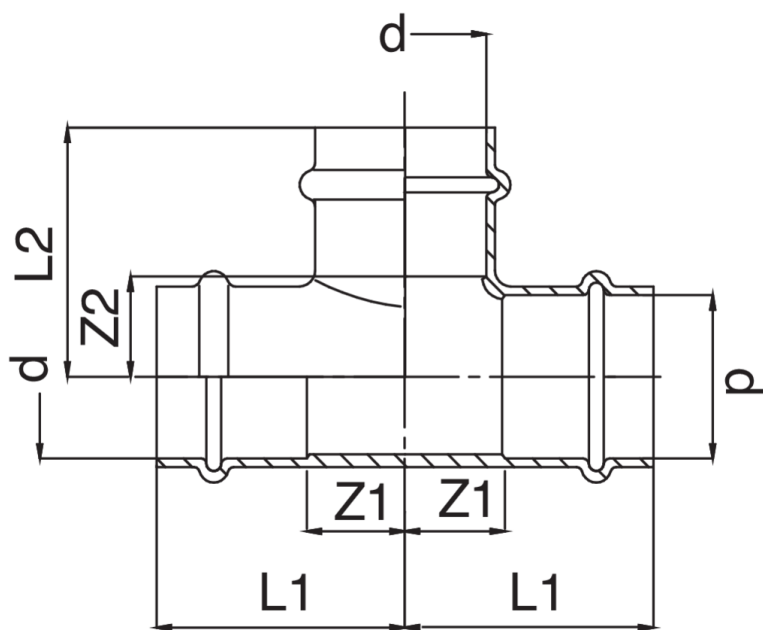

D	BAG	MASTER BOX	CÓDIGO	L1	L2	Z1	Z2
12	10	150	PG9130012012012	29	29	11	11
15	10	100	PG9130015015015	41	33	19	11
18	5	50	PG9130018018018	42	35	19	12
22	5	40	PG9130022022022	45	39	21	15
28	5	35	PG9130028028028	48	46	23	21
35	5	20	PG9130035035035	53	48	27	22
42	1	10	PG9130042042042	65	65	29	29
54	1	10	PG9130054054054	75	75	35	35

# Aplicaciones



GAS



INDUSTRIAL



COMPRESSED  
AIR