

Manguito mixto M/rosca hembra de bronce.

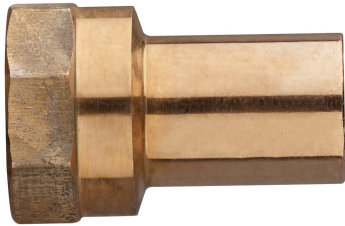

Especificaciones técnicas

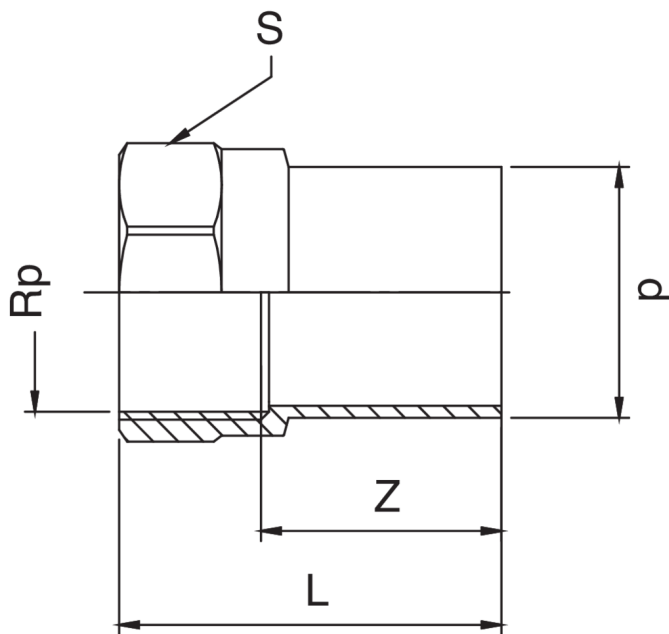

| D X RP | BAG | MASTER BOX | CÓDIGO | L | S | Z |
|------------|-----|------------|-----------------|----|----|----|
| 12 x 3/8" | 10 | 200 | RS8272A38012000 | 37 | 21 | 25 |
| 12 x 1/2" | 10 | 200 | RS8272A12012000 | 41 | 25 | 26 |
| 15 x 3/8" | 10 | 200 | RS8272A38015000 | 41 | 21 | 29 |
| 15 x 1/2" | 10 | 200 | RS8272A12015000 | 45 | 25 | 30 |
| 18 x 1/2" | 10 | 150 | RS8272A12018000 | 46 | 25 | 31 |
| 18 x 3/4" | 10 | 100 | RS8272A34018000 | 48 | 31 | 31 |
| 22 x 1/2" | 10 | 100 | RS8272A12022000 | 47 | 25 | 32 |
| 22 x 3/4" | 10 | 80 | RS8272A34022000 | 49 | 31 | 32 |
| 28 x 1" | 5 | 40 | RS8272B01028000 | 54 | 38 | 34 |
| 35 x 1"1/4 | 5 | 20 | RS8272B14035000 | 57 | 48 | 35 |
| 42 x 1"1/2 | 5 | 20 | RS8272B12042000 | 68 | 55 | 46 |
| 54 x 2" | 1 | 10 | RS8272C02054000 | 76 | 68 | 50 |

Aplicaciones



GAS



INDUSTRIAL



COMPRESSED
AIR