

RB3331

Male/female thread 3-piece flat seat joint.

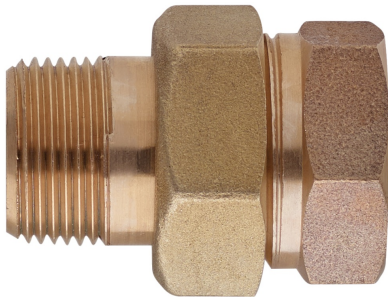

Technical specifications

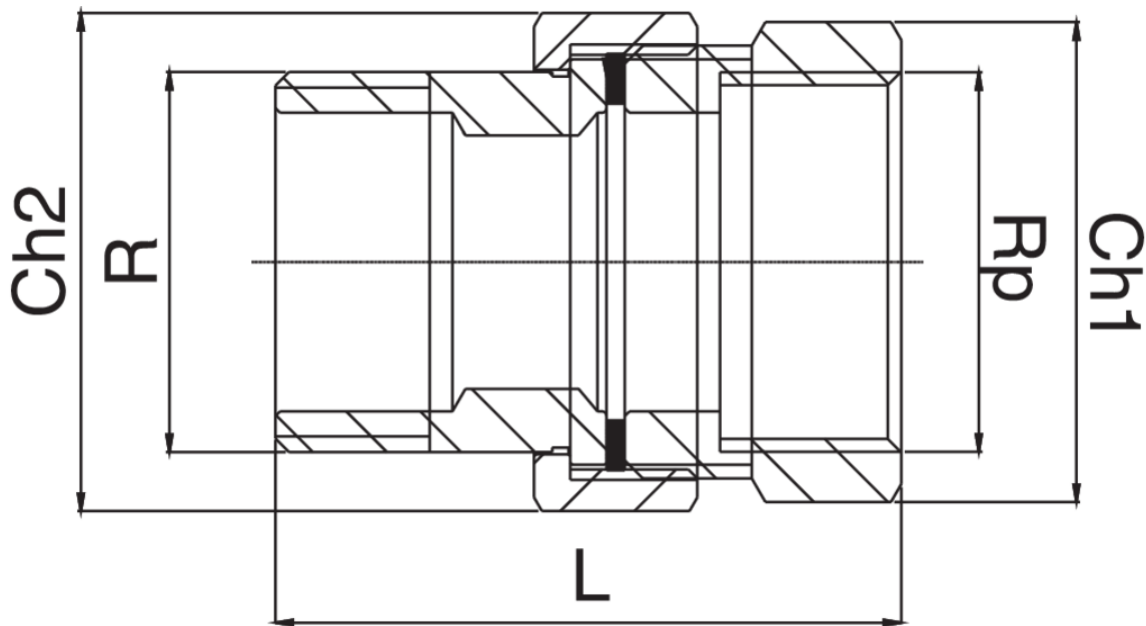

| R/RP | BAG | MASTER BOX | CODE | CH1 | CH2 | L |
|-------|-----|------------|-----------------|-----|-----|------|
| 3/8" | 5 | 150 | RB3331A38A38000 | 24 | 27 | 44 |
| 1/2" | 5 | 100 | RB3331A12A12000 | 27 | 30 | 47,5 |
| 3/4" | 5 | 50 | RB3331A34A34000 | 34 | 37 | 53,5 |
| 1" | 5 | 40 | RB3331B01B01000 | 42 | 46 | 61,5 |
| 1"1/4 | 1 | 20 | RB3331B14B14000 | 50 | 52 | 69,5 |
| 1"1/2 | 1 | 15 | RB3331B12B12000 | 56 | 64 | 88 |
| 2" | 1 | 8 | RB3331C02C02000 | 70 | 82 | 96 |

Applications



DRINKING WATER



HEATING



HVAC



GAS



COMPRESSED AIR



SOLAR



FIREFIGHTING