

## KR5090

Female thread elbow.

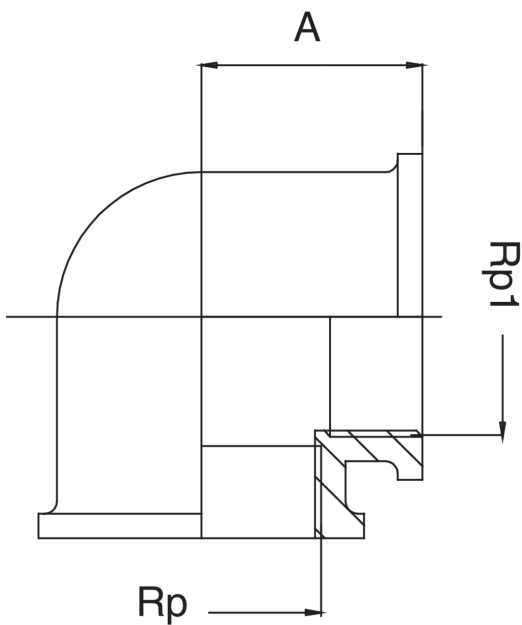

### Technical specifications



| RP X RP1    | BAG | MASTER BOX | CODE            | A  |
|-------------|-----|------------|-----------------|----|
| 3/8" x 3/8" | 10  | 150        | KR5090A38A38000 | 21 |
| 1/2" x 1/2" | 10  | 100        | KR5090A12A12000 | 25 |
| 3/4" x 3/4" | 10  | 70         | KR5090A34A34000 | 27 |
| 1" x 1"     | 5   | 40         | KR5090B01B01000 | 21 |

# Applications

---



DRINKING  
WATER



HEATING



HVAC