

B5358G

Female thread valve connector with a swivel nut in brass.

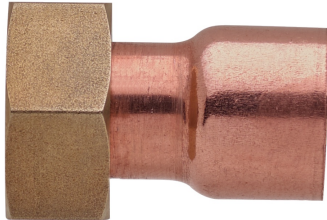

Technical specifications

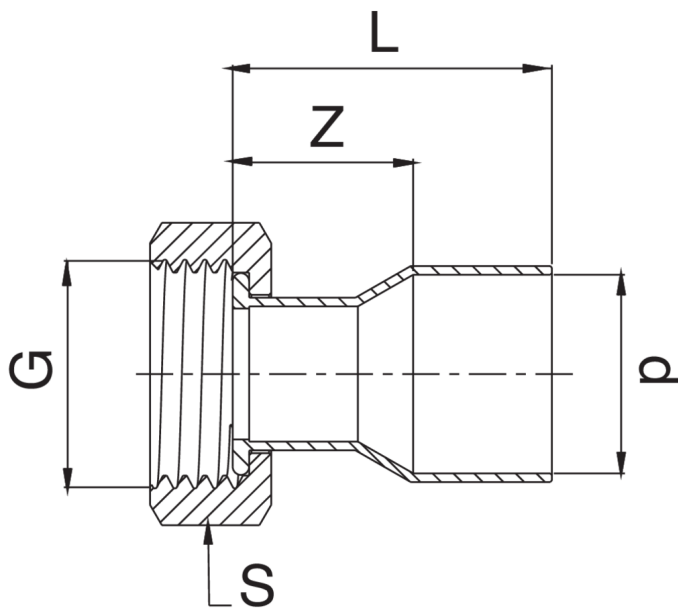

| D X G | BAG | MASTER BOX | CODE | L MIN | S | Z |
|------------|-----|------------|-----------------|-------|----|----|
| 12 x 3/8" | 10 | 150 | B5358GA38012000 | 22 | 21 | 13 |
| 12 x 1/2" | 10 | 250 | B5358GA12012000 | 25 | 24 | 16 |
| 12 x 3/4" | 10 | 200 | B5358GA34012000 | 25 | 30 | 16 |
| 14 x 1/2" | 10 | 250 | B5358GA12014000 | 25 | 24 | 14 |
| 14 x 3/4" | 10 | 200 | B5358GA34014000 | 26 | 30 | 15 |
| 15 x 1/2" | 10 | 250 | B5358GA12015000 | 25 | 24 | 14 |
| 15 x 3/4" | 10 | 200 | B5358GA34015000 | 27 | 30 | 16 |
| 16 x 1/2" | 10 | 200 | B5358GA12016000 | 25 | 24 | 14 |
| 16 x 3/4" | 10 | 200 | B5358GA34016000 | 27 | 30 | 16 |
| 18 x 3/4" | 10 | 150 | B5358GA34018000 | 28 | 30 | 15 |
| 18 x 1" | 10 | 100 | B5358GB01018000 | 31 | 37 | 18 |
| 22 x 3/4" | 10 | 150 | B5358GA34022000 | 34 | 30 | 19 |
| 22 x 1" | 10 | 100 | B5358GB01022000 | 35 | 37 | 20 |
| 28 x 1"1/4 | 10 | 50 | B5358GB14028000 | 39 | 46 | 21 |
| 54 x 2" | 1 | 16 | B5358GC02054000 | 67 | 64 | 35 |

Applications



DRINKING
WATER



HEATING



HVAC



GAS



COMPRESSED
AIR



SOLAR



INDUSTRIAL