

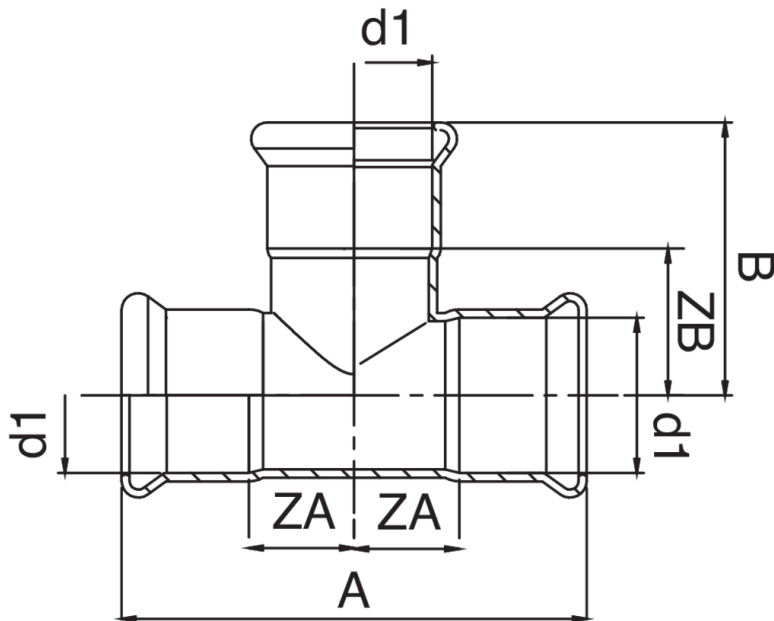

Copper F/F/F tee.

Technical specifications



| D1 | BAG | MASTER BOX | CODE | A | B | ZA | ZB |
|----|-----|------------|-----------------|-----|----|----|----|
| 12 | 10 | 150 | QM9130012012012 | 56 | 28 | 10 | 10 |
| 15 | 10 | 100 | QM9130015015015 | 64 | 32 | 12 | 12 |
| 18 | 5 | 50 | QM9130018018018 | 68 | 34 | 14 | 14 |
| 22 | 5 | 40 | QM9130022022022 | 74 | 37 | 14 | 14 |
| 28 | 5 | 35 | QM9130028028028 | 84 | 42 | 19 | 19 |
| 35 | 5 | 20 | QM9130035035035 | 100 | 50 | 24 | 24 |
| 42 | 1 | 10 | QM9130042042042 | 116 | 58 | 28 | 28 |
| 54 | 1 | 10 | QM9130054054054 | 138 | 69 | 34 | 34 |

Applications



COMPRESSED
AIR



GAS



INDUSTRIAL