

## Technical specifications

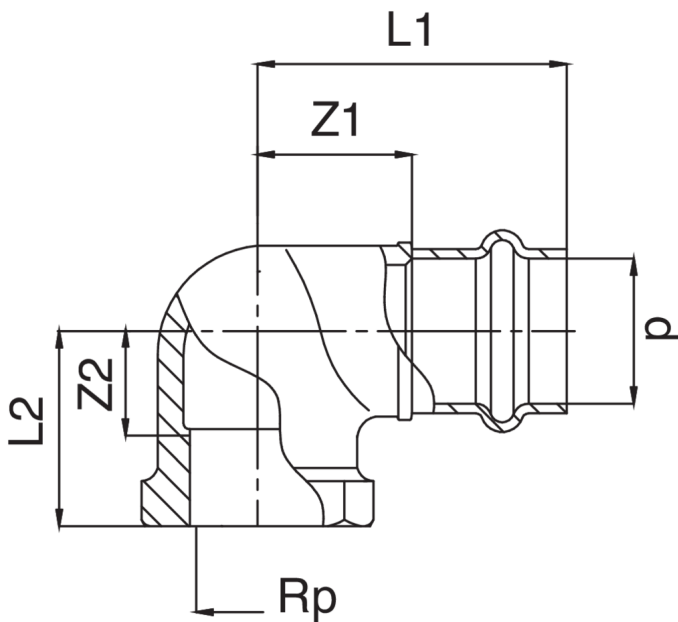

D X RP	BAG	MASTER BOX	CODE	L1	L2	Z1	Z2
12 x 3/8"	10	150	RS8090A38012000	44	18	26	9
12 x 1/2"	10	150	RS8090A12012000	44	22	26	11
15 x 3/8"	10	100	RS8090A38015000	47	19	25	10
15 x 1/2"	10	100	RS8090A12015000	45	24	23	13
15 x 3/4"	10	70	RS8090A34015000	49	31	27	16
18 x 1/2"	10	100	RS8090A12018000	47	24	24	13
18 x 3/4"	5	70	RS8090A34018000	50	24	27	9
22 x 1/2"	10	60	RS8090A12022000	49	24	25	13
22 x 3/4"	5	60	RS8090A34022000	49	29	25	6
22 x 1"	5	40	RS8090B01022000	60	33	36	10
28 x 3/4"	5	50	RS8090A34028000	55	30	30	15
28 x 1"	5	40	RS8090B01028000	61	33	36	9
35 x 1"1/4	5	20	RS8090B14035000	67	40	41	22
42 x 1"1/2	5	20	RS8090B12042000	77	43	41	25
54 x 2"	1	8	RS8090C02054000	97	57	57	39

## Applications



DRINKING WATER



HEATING



HVAC



GAS



COMPRESSED AIR



FIREFIGHTING