

RB3280

Messing Nippel mit A Gewinde.

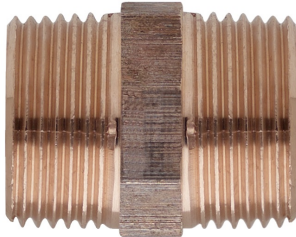

Technische Spezifikationen

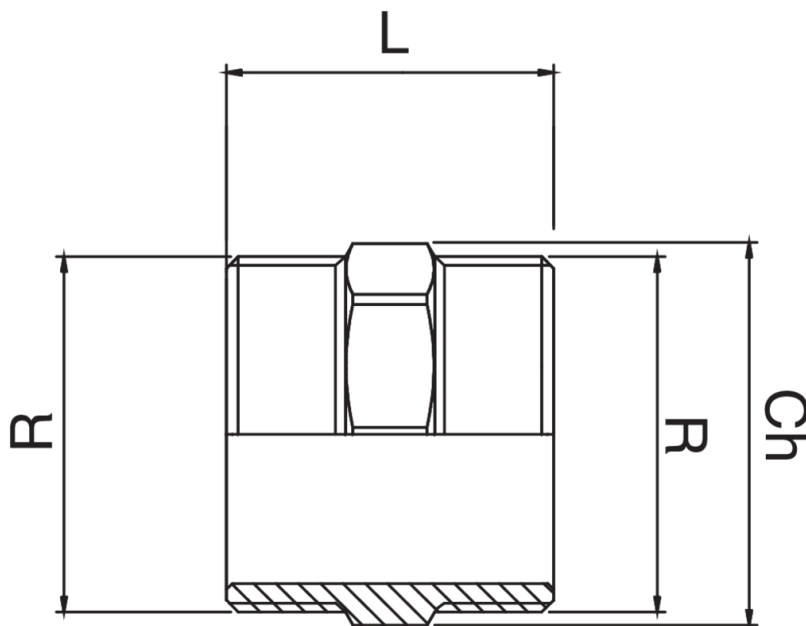

R	BAG	MASTER BOX	CODE	CH	L
1/4"	10	250	RB3280A14A14000	17	25
3/8"	10	500	RB3280A38A38000	17	26
1/2"	10	250	RB3280A12A12000	21	30
3/4"	10	100	RB3280A34A34000	27	33
1"	10	100	RB3280B01B01000	34	40
1"1/4	5	50	RB3280B14B14000	42	45
1"1/2	5	40	RB3280B12B12000	48	47
2"	5	25	RB3280C02C02000	60	55
2"1/2	1	8	RB3280C12C12000	90	65
3"	1	15	RB3280D03D03000	95	75

Anwendungen



DRINKING WATER



HEATING



HVAC



GAS



COMPRESSED AIR



SOLAR



FIREFIGHTING