

## OT5521

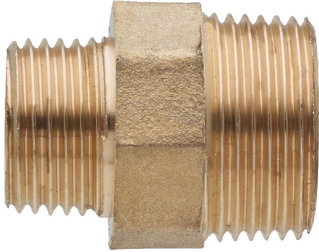

Nippel reduziert mit A Gewinde.

### Technische Spezifikationen

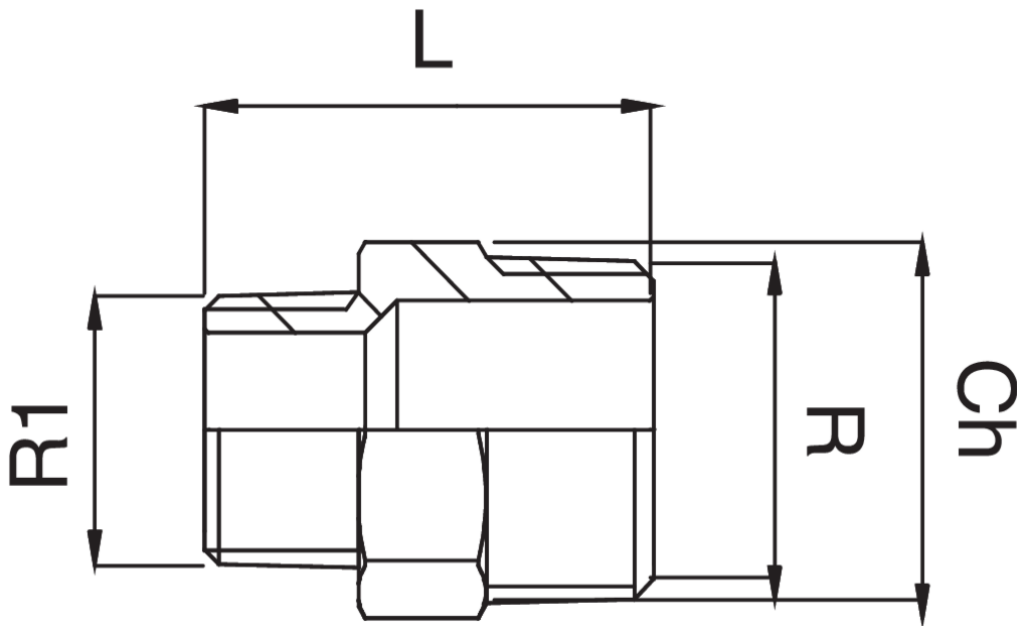

| R X R1        | BAG | MASTER BOX | CODE            | L    | CH |
|---------------|-----|------------|-----------------|------|----|
| 1/4" x 1/8"   | 10  | 100        | OT5521A14A18000 | 22   | 14 |
| 3/8" x 1/4"   | 10  | 300        | OT5521A38A14000 | 25   | 18 |
| 1/2" x 1/4"   | 10  | 200        | OT5521A12A14000 | 25   | 19 |
| 1/2" x 3/8"   | 10  | 300        | OT5521A12A38000 | 25,5 | 21 |
| 3/4" x 1/2"   | 10  | 150        | OT5521A34A12000 | 35   | 27 |
| 1" x 1/2"     | 10  | 100        | OT5521B01A12000 | 32,5 | 34 |
| 1" x 3/4"     | 10  | 100        | OT5521B01A34000 | 34   | 34 |
| 1"1/4 x 3/4"  | 5   | 50         | OT5521B14A34000 | 41   | 42 |
| 1"1/4 x 1"    | 5   | 50         | OT5521B14B01000 | 43   | 42 |
| 1"1/2 x 3/4"  | 5   | 50         | OT5521B12A34000 | 43   | 48 |
| 1"1/2 x 1"    | 5   | 50         | OT5521B12B01000 | 45   | 48 |
| 1"1/2 x 1"1/4 | 5   | 40         | OT5521B12B14000 | 47   | 48 |
| 2" x 1"       | 5   | 30         | OT5521C02B01000 | 50   | 60 |
| 2" x 1"1/4    | 5   | 30         | OT5521C02B14000 | 52   | 60 |
| 2" x 1"1/2    | 5   | 25         | OT5521C02B12000 | 53   | 60 |
| 2"1/2 x 2"    | 1   | 10         | OT5521C12C02000 | 60   | 78 |
| 3" x 2"       | 1   | 5          | OT5521D03C02000 | 62   | 90 |
| 3" x 2"1/2    | 1   | 10         | OT5521D03C12000 | 64   | 90 |

## Anwendungen



DRINKING  
WATER



HEATING



HVAC



GAS



COMPRESSED  
AIR



SOLAR



FIREFIGHTING