

## Technische Spezifikationen

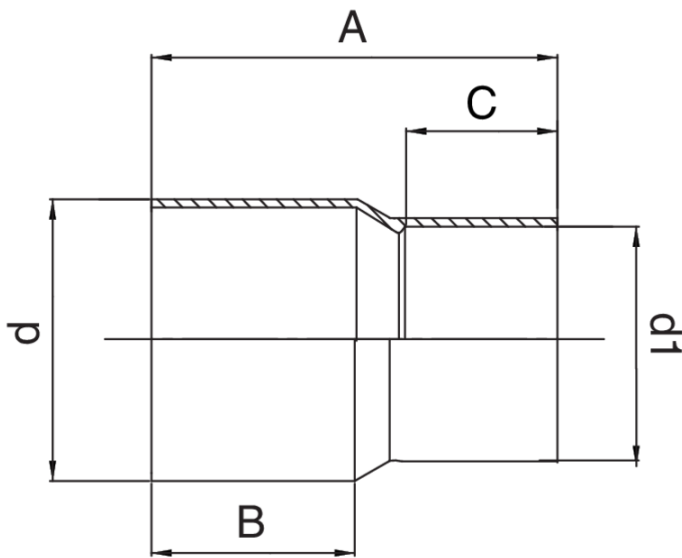

D X D1	BAG	MASTER BOX	CODE	A	B MIN	C MIN
22 x 14	10	300	RG5243022014000	38	17,4	10,6
22 x 16	10	300	RG5243022016000	37	17,4	10,6
22 x 18	10	300	RG5243022018000	40	17,4	12,6
28 x 16	10	200	RG5243028016000	44	20,4	10,6
28 x 22	10	200	RG5243028022000	43	20,4	15,4
35 x 18	10	150	RG5243035018000	50	25	12,6
35 x 22	10	200	RG5243035022000	54	25	15,4
35 x 28	10	150	RG5243035028000	57	25	18,4
42 x 22	5	100	RG5243042022000	61	29	15,4
42 x 28	5	100	RG5243042028000	62,5	29	18,4
42 x 35	5	70	RG5243042035000	60	29	23
54 x 35	5	70	RG5243054035000	78	34	23
54 x 42	5	70	RG5243054042000	76	34	27
64 x 42	1	10	RG5243064042000	80	34,5	27
89 x 76	1	8	RG5243089076000	91	39,5	33,5
108 x 76	1	6	RG5243108076000	111	52	33,5
108 x 89	1	6	RG5243108089000	107	52	37,5
133 x 89	1	8	RG5243133089000	119	54	37,5
133 x 108	1	8	RG5243133108000	126	54	47,5

## Anwendungen



GAS



COMPRESSED  
AIR



SOLAR



INDUSTRIAL



REFRIGERATION



DRINKING  
WATER



HVAC