

RR5040

Bogen 45° I/A.

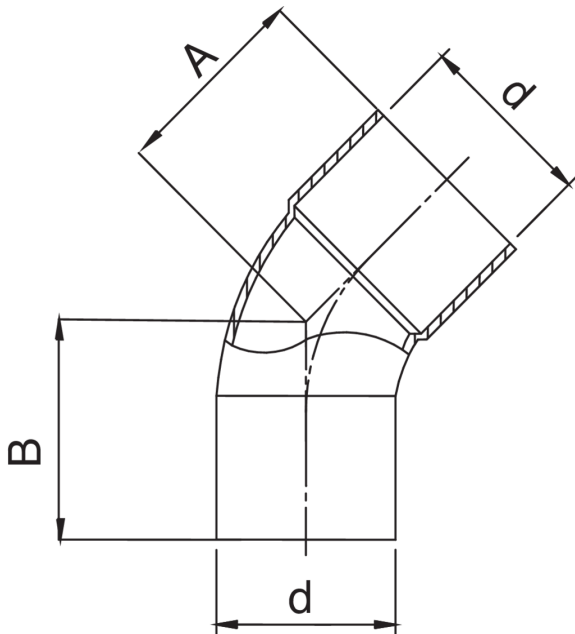

Technische Spezifikationen



| D | BAG | MASTER BOX | CODE | A | B |
|------|-----|------------|-----------------|------|------|
| 6 | 10 | 1000 | RR5040006006000 | 14 | 19 |
| 8 | 10 | 1000 | RR5040008008000 | 14 | 19 |
| 10 | 25 | 800 | RR5040010010000 | 12 | 14 |
| 12 | 10 | 600 | RR5040012012000 | 13 | 14,5 |
| 14 | 10 | 400 | RR5040014014000 | 15 | 17 |
| 15 | 10 | 400 | RR5040015015000 | 15 | 17 |
| 16 | 10 | 500 | RR5040016016000 | 15,5 | 17,5 |
| 18 | 10 | 250 | RR5040018018000 | 18 | 20 |
| 20 | 10 | 400 | RR5040020020000 | 21 | 23 |
| 22 | 10 | 100 | RR5040022022000 | 21,5 | 23,5 |
| 28 | 10 | 80 | RR5040028028000 | 25,5 | 27,5 |
| 32 | 5 | 100 | RR5040032032000 | 31,5 | 33,5 |
| 35 | 5 | 100 | RR5040035035000 | 33 | 35 |
| 36 | 5 | 100 | RR5040036036000 | 33,5 | 35 |
| 40 | 5 | 80 | RR5040040040000 | 37 | 39 |
| 42 | 5 | 50 | RR5040042042000 | 38 | 40 |
| 52 | 5 | 10 | RR5040052052000 | 45 | 48 |
| 54 | 1 | 10 | RR5040054054000 | 46 | 48 |
| 63 | 1 | 20 | RR5040063063000 | 52,5 | 56 |
| 64 | 1 | 25 | RR5040064064000 | 62 | 64 |
| 66,7 | 1 | 15 | RR5040067067000 | 52,5 | 57 |
| 76,1 | 1 | 15 | RR5040076076000 | 58 | 62 |
| 88,9 | 1 | 5 | RR5040089089000 | 65 | 70 |
| 108 | 1 | 2 | RR5040108108000 | 79 | 82 |

Anwendungen



DRINKING
WATER



HEATING



HVAC



GAS



COMPRESSED
AIR



SOLAR



INDUSTRIAL