

T-Stück I/I/I.

## Technische Spezifikationen

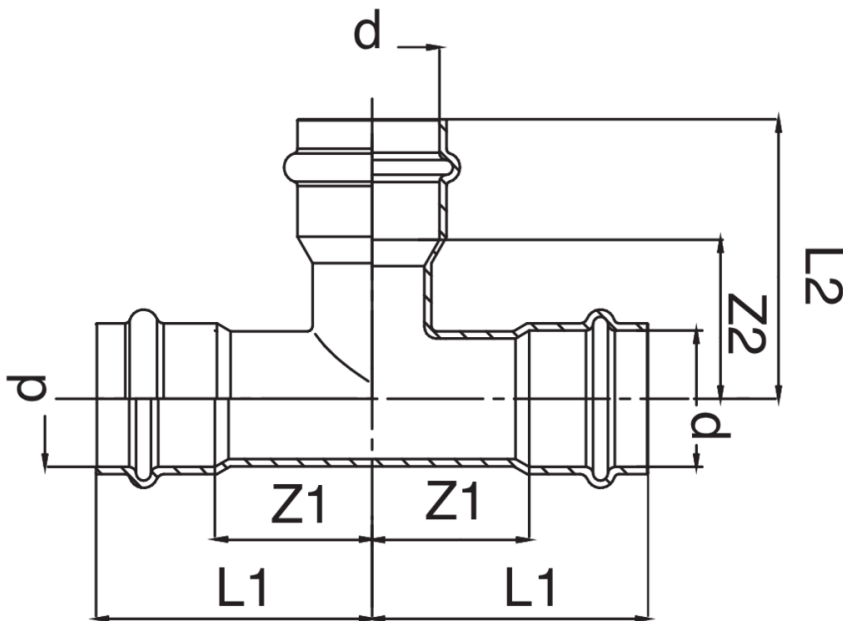

| D  | BAG | MASTER BOX | CODE            | L1 | L2 | Z1 | Z2 |
|----|-----|------------|-----------------|----|----|----|----|
| 15 | 5   | 40         | GX0130015015015 | 42 | 44 | 20 | 22 |
| 18 | 5   | 50         | GX0130018018018 | 46 | 49 | 23 | 26 |
| 22 | 5   | 30         | GX0130022022022 | 49 | 53 | 25 | 29 |
| 28 | 5   | 20         | GX0130028028028 | 56 | 57 | 31 | 34 |
| 35 | 1   | 15         | GX0130035035035 | 66 | 63 | 42 | 37 |
| 42 | 1   | 10         | GX0130042042042 | 78 | 76 | 44 | 40 |
| 54 | 1   | 5          | GX0130054054054 | 82 | 92 | 42 | 51 |

# Anwendungen



GAS



COMPRESSED  
AIR



INDUSTRIAL