

Muffe I/I aus Kupfer.

## Technische Spezifikationen

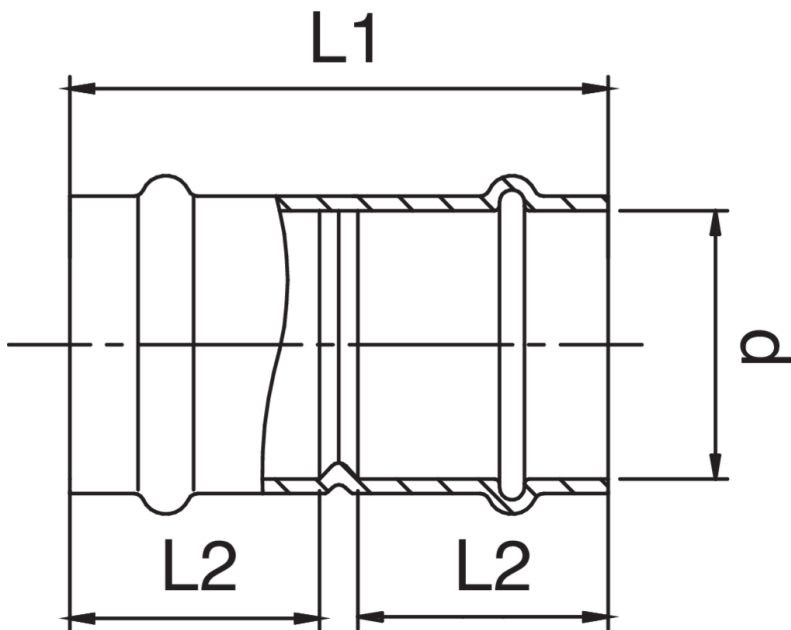

| D  | BAG | MASTER BOX | CODE            | L1 | L2 |
|----|-----|------------|-----------------|----|----|
| 12 | 10  | 300        | PG9270012012000 | 40 | 18 |
| 15 | 10  | 200        | PG9270015015000 | 49 | 22 |
| 18 | 10  | 150        | PG9270018018000 | 52 | 23 |
| 22 | 10  | 100        | PG9270022022000 | 53 | 24 |
| 28 | 10  | 60         | PG9270028028000 | 57 | 25 |
| 35 | 5   | 40         | PG9270035035000 | 62 | 26 |
| 42 | 5   | 25         | PG9270042042000 | 78 | 35 |
| 54 | 1   | 15         | PG9270054054000 | 93 | 40 |

# Anwendungen



GAS



INDUSTRIAL



COMPRESSED  
AIR