

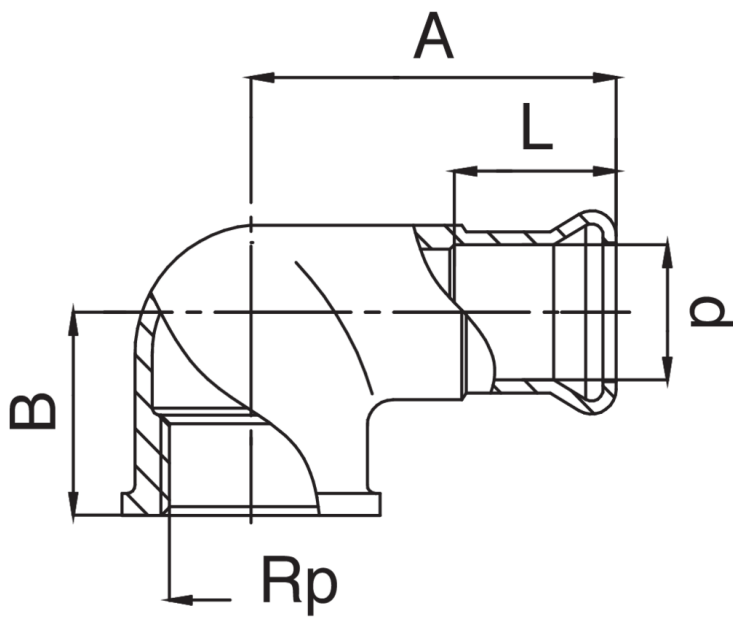

Winkel 90° I mit I Gewinde aus Rotguss.



Technische Spezifikationen



| D X RP | BAG | MASTER BOX | CODE | A | B | L |
|------------|-----|------------|-----------------|----|------|------|
| 12 x 3/8" | 10 | 150 | ZM8090A38012000 | 33 | 18 | 15,5 |
| 12 x 1/2" | 10 | 150 | ZM8090A12012000 | 40 | 22 | 15,5 |
| 15 x 3/8" | 10 | 100 | ZM8090A38015000 | 35 | 19 | 18,5 |
| 15 x 1/2" | 10 | 100 | ZM8090A12015000 | 38 | 23 | 18,5 |
| 15 x 3/4" | 10 | 70 | ZM8090A34015000 | 41 | 24 | 18,5 |
| 18 x 1/2" | 10 | 100 | ZM8090A12018000 | 38 | 23 | 18,5 |
| 18 x 3/4" | 5 | 70 | ZM8090A34018000 | 41 | 24 | 18,5 |
| 22 x 1/2" | 10 | 60 | ZM8090A12022000 | 41 | 25 | 21,5 |
| 22 x 3/4" | 5 | 60 | ZM8090A34022000 | 44 | 29,5 | 21,5 |
| 22 x 1" | 5 | 40 | ZM8090B01022000 | 47 | 32 | 21,5 |
| 28 x 1" | 5 | 40 | ZM8090B01028000 | 52 | 32 | 22 |
| 35 x 1"1/4 | 1 | 20 | ZM8090B14035000 | 60 | 40 | 24,5 |
| 42 x 1"1/2 | 1 | 20 | ZM8090B12042000 | 66 | 41 | 28,5 |
| 54 x 2" | 1 | 8 | ZM8090C02054000 | 77 | 55 | 33,5 |

Anwendungen



DRINKING
WATER



HEATING



HVAC



COMPRESSED
AIR



FIREFIGHTING