

Übergangsstück I mit A Gewinde.

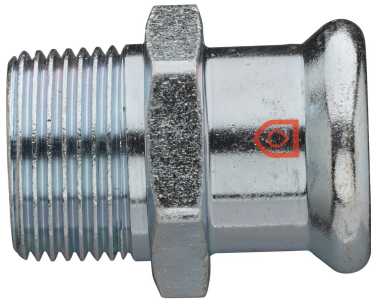

## Technische Spezifikationen

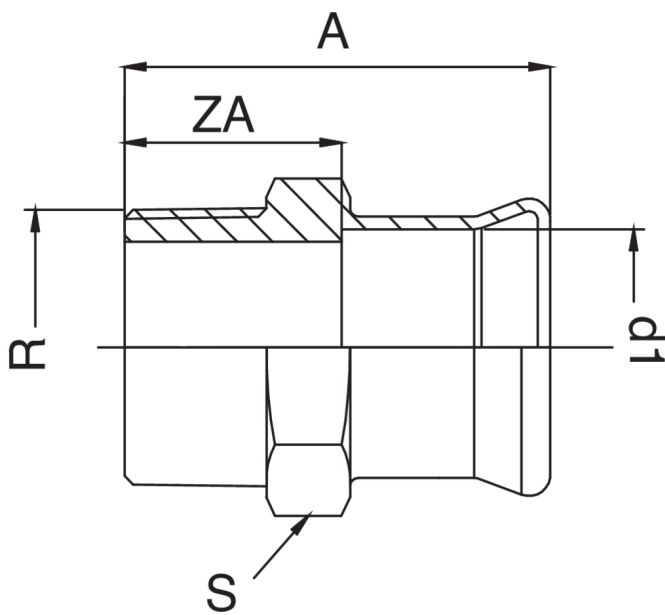

| D1 X R       | BAG | MASTER BOX | CODE            | A     | S   | ZA   |
|--------------|-----|------------|-----------------|-------|-----|------|
| 66,7 x 2"1/2 | 1   | 15         | ACF243C12067000 | -     | -   | -    |
| 76,1 x 2"1/2 | 1   | 8          | ACF243C12076000 | 114   | 86  | 59   |
| 88,9 x 3"    | 1   | 5          | ACF243D03089000 | 125,5 | 98  | 65,5 |
| 108 x 4"     | 1   | 3          | ACF243E04108000 | 151   | 122 | 81   |

## Anwendungen



HEATING



HVAC



COMPRESSED  
AIR