

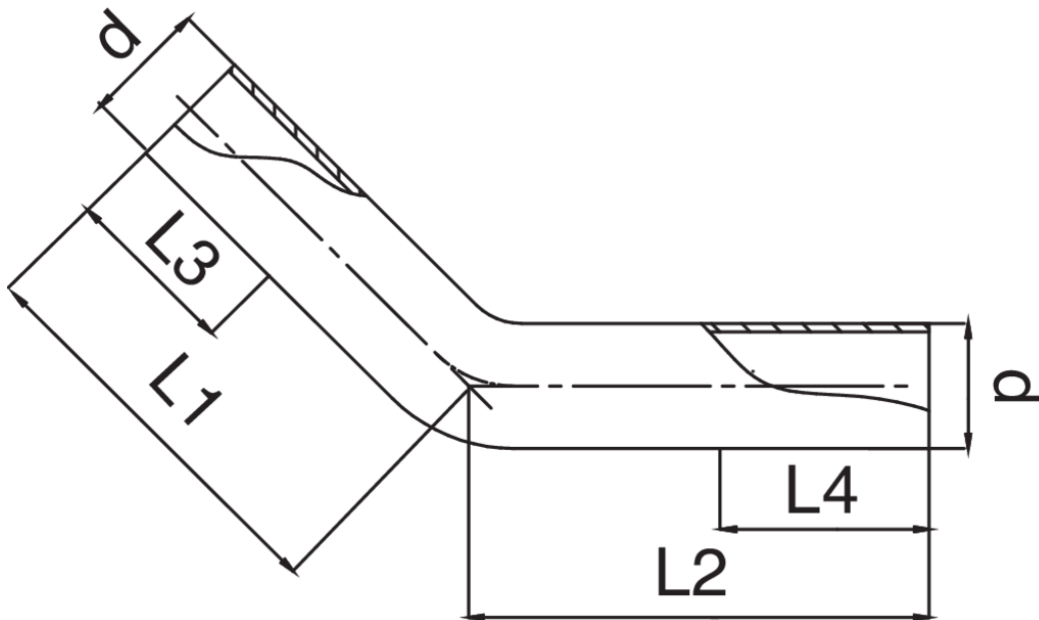

Gebogene Rohrstücke A/A 45°.

Technische Spezifikationen



D	BAG	MASTER BOX	CODE	L1	L2	L3 MIN	L4 MIN
15	10	40	ZX0045015015000	62	120	25	25
18	10	30	ZX0045018018000	58	124	25	25
22	5	20	ZX0045022022000	56	120	30	30
28	5	15	ZX0045028028000	58	122	30	30
35	5	10	ZX0045035035000	94	206	30	30
42	1	5	ZX0045042042000	114	262	45	45
54	1	5	ZX0045054054000	146	321	65	65

Anwendungen



DRINKING
WATER



HEATING



HVAC



COMPRESSED
AIR



FIREFIGHTING



MARINE



STEAM



SOLAR



INDUSTRIAL

