

T H/H/H de cobre.

Especificaciones técnicas

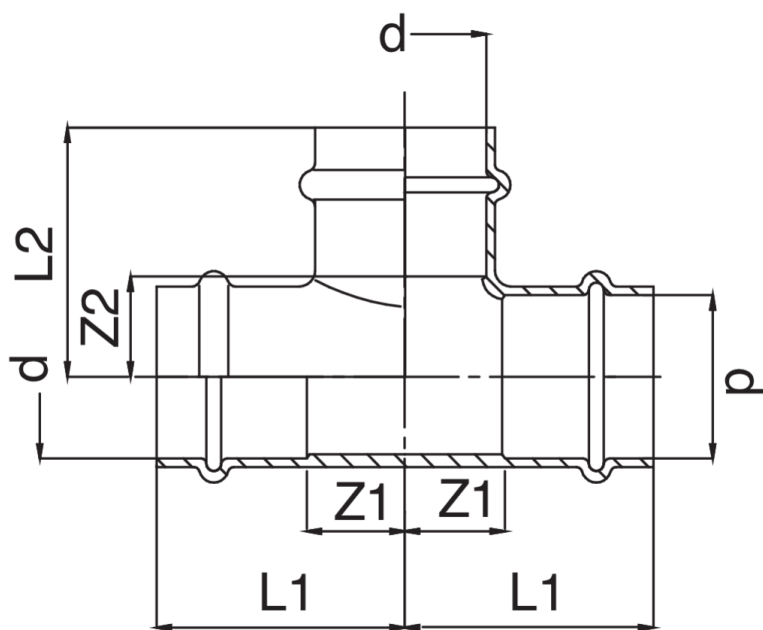

| D | BAG | MASTER BOX | CÓDIGO | L1 | L2 | Z1 | Z2 |
|----|-----|------------|-----------------|----|----|----|----|
| 12 | 10 | 150 | PG9130012012012 | 29 | 29 | 11 | 11 |
| 15 | 10 | 100 | PG9130015015015 | 41 | 33 | 19 | 11 |
| 18 | 5 | 50 | PG9130018018018 | 42 | 35 | 19 | 12 |
| 22 | 5 | 40 | PG9130022022022 | 45 | 39 | 21 | 15 |
| 28 | 5 | 35 | PG9130028028028 | 48 | 46 | 23 | 21 |
| 35 | 5 | 20 | PG9130035035035 | 53 | 48 | 27 | 22 |
| 42 | 1 | 10 | PG9130042042042 | 65 | 65 | 29 | 29 |
| 54 | 1 | 10 | PG9130054054054 | 75 | 75 | 35 | 35 |

Aplicaciones



GAS



INDUSTRIAL



COMPRESSED
AIR